



BIGFOOT

Portable Sound Systems

Perfect for...

- Indoor & Outdoor Events
- Football Field
- Schools & Universities
- Sporting Events
- Marching Bands
- Graduations
- Large Auditoriums
- Assemblies
- House of Worship
- Parks & Recreation
- Auctions
- Military Training & Ceremonies
- Fitness Centers
- Parades & Community Celebrations
- Ceremonies
- Public Gatherings
- Weddings
- and more!

MADE IN THE USA



SIX YEAR WARRANTY



Anchor Audio Inc.
800.262.4671 • sales@anchoraudio.com
anchoraudio.com

FEATURES

- Reaches crowds of 5,000+
- 130 dB of clear sound
- 400W AC/DC mode
- Up to four built-in wireless receivers
- Standard built-in Bluetooth
- Optional built-in CD/MP3 combo player
- Two universal microphone input jacks
- 3.5 mm AUX line input
- Onboard mic storage bag
- Durable enclosure with heavy duty wheels
- Built-in rechargeable batteries operate 6 - 8 hours on a single charge
- Five 8" neodymium woofers
- One neodymium compression driver
- Designed to cover a football field or large auditorium

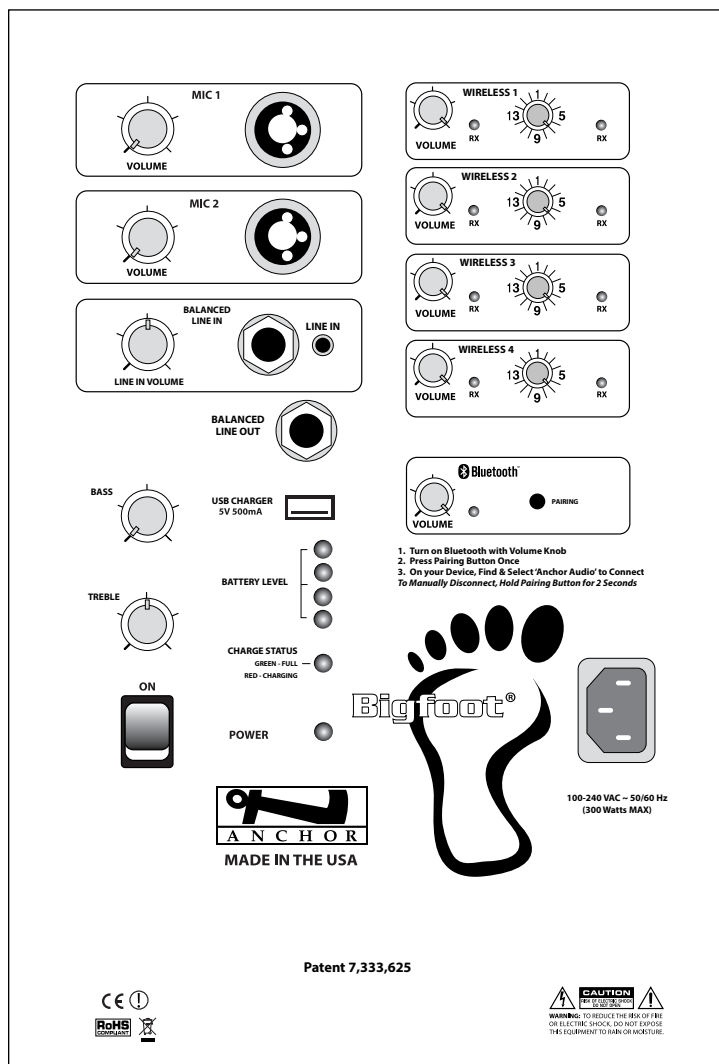

(BIG-8000U4 Back Panel Shown)

Bigfoot Models

Bigfoot Models	
BIG-8000	Bigfoot with Bluetooth
BIG-8000U1	Bigfoot with Bluetooth & 1 wireless receiver
BIG-8000U2	Bigfoot with Bluetooth & 2 wireless receivers
BIG-8000U3	Bigfoot with Bluetooth & 3 wireless receivers
BIG-8000U4	Bigfoot with Bluetooth & 4 wireless receivers
BIG-8000C	Bigfoot with Bluetooth & CD/MP3 combo player
BIG-8000CU1	Bigfoot with Bluetooth, CD/MP3 combo player & 1 wireless receiver
BIG-8000CU2	Bigfoot with Bluetooth, CD/MP3 combo player & 2 wireless receivers
BIG-8000CU3	Bigfoot with Bluetooth, CD/MP3 combo player & 3 wireless receivers
BIG-8000CU4	Bigfoot with Bluetooth, CD/MP3 combo player & 4 wireless receivers
Wireless Microphones & Transmitters	
WH-8000	Wireless handheld microphone
WB-8000	Wireless beltpack transmitter (requires handsfree microphone) Microphone options include: Headband/HBM-TA4F, Collar/CM-60, Over-the-Ear/EM-TA4F, or Lapel/LM-60

Technical Specifications

Rated Power Output	400 watts AC/DC
Max SPL @ Rated Power	130 dB @ 1 meter
Battery	Three 12V sealed lead acid rechargeable, 9.0 AH Full recharge: approx 8 hrs
Frequency Response	100 Hz - 15 kHz ± 3dB
Wireless Range	150' line of sight
Line Output (post fader)	isolated, 600Ω, 1/4" phone
AC Power Reqs.	100 - 240 VAC, 50/60 Hz, 300W max
USB	5V 500mA
Dimensions Closed (HWD)	42.5" x 15.3" x 24" (108 x 38.9 x 61 cm)
Dimensions Opened (HWD)	68.5" x 15.3" x 24" (174 x 38.9 x 61 cm)
Base Model Weight	73.5 lbs / 33.3 Kg
Mic Inputs:	Lo-Z (1 KW), balanced, XLR 12 VDC condenser mic (phantom) power Hi-Z (10 KW), unbalanced, 1/4" phone balanced
Line In	balanced, 1/4" & 3.5mm stereo
Sensitivity For Rated Output	
Lo-Z Microphone	-52 dBV (2.5 mVrms)
Hi-Z Microphone	-43 dBV (7.5 mVrms)
Auxiliary (line)	-14 dBV (200 mVrms)



(Features & Specifications Subject to Change Without Notice)