



BEACON

Portable Sound System

Perfect for...

- Indoor & Outdoor Events
- Schools & Universities
- Sporting Events
- Graduations
- Auditoriums
- Assemblies
- House of Worship
- Parks & Recreation
- Auctions
- Military Training & Ceremonies
- Fitness Centers
- Parades & Community Celebrations
- Ceremonies
- Rental
- Public Gatherings
- Weddings
- and more!

MADE IN THE USA



SIX YEAR WARRANTY



Anchor Audio Inc.
800.262.4671 • sales@anchoraudio.com
anchoraudio.com

Beacon Line Array

FEATURES

- Reaches crowds of 2,500+
- 120 dB of clear sound
- 150W AC mode / 125W DC mode
- Up to two built-in wireless receivers
- Standard built-in Bluetooth
- Optional built-in CD/MP3 combo player
- Two universal microphone input jacks
- 3.5 mm AUX line input
- Nylon mesh storage bag
- Durable enclosure case with wheels and retractable handle
- Built-in rechargeable batteries operate 6 - 8 hours on a single charge
- Lightweight array tower has eight 4" neodymium speakers
- Base has three 8" neodymium subwoofers

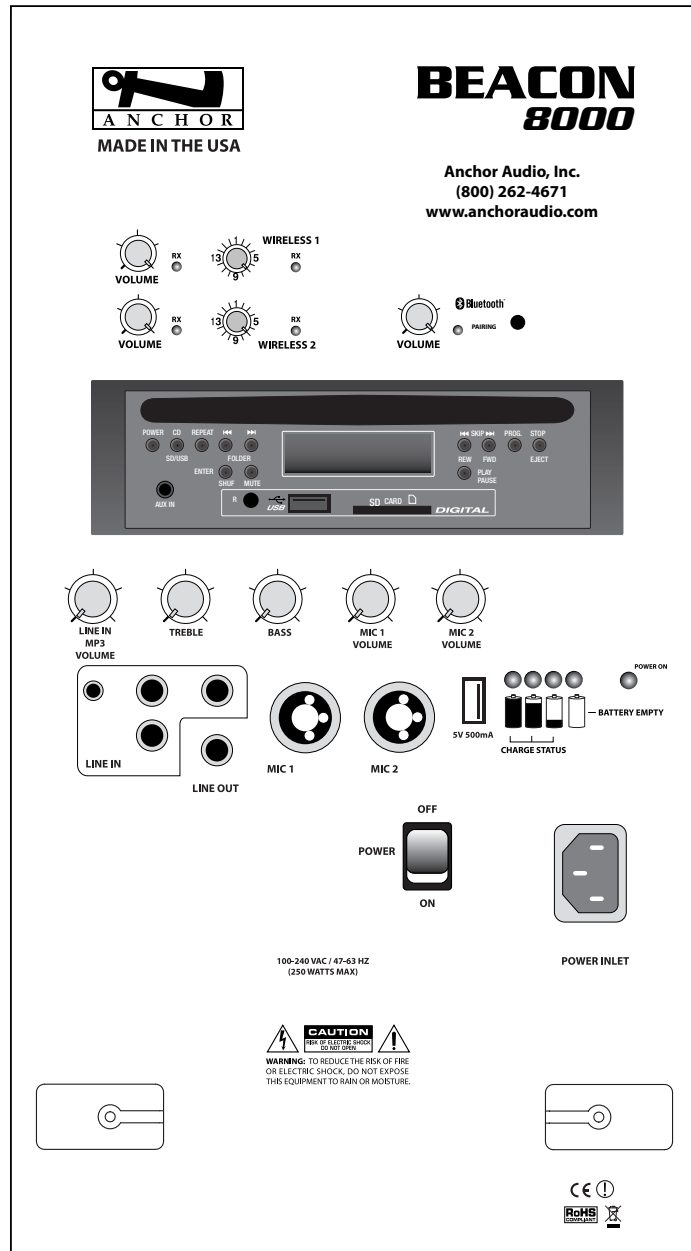

(BEA-8000CU2 Back Panel Shown)

Beacon Models	
BEA-8000	Beacon with Bluetooth
BEA-8000U1	Beacon with Bluetooth & 1 wireless receiver
BEA-8000U2	Beacon with Bluetooth & 2 wireless receivers
BEA-8000C	Beacon with Bluetooth & CD/MP3 combo player
BEA-8000CU1	Beacon with Bluetooth, CD/MP3 combo player & 1 wireless receiver
BEA-8000CU2	Beacon with Bluetooth, CD/MP3 combo player & 2 wireless receivers
Wireless Microphones & Transmitters	
WH-8000	Wireless handheld microphone
WB-8000	Wireless belt-pack transmitter (requires handsfree microphone) Microphone options include: Headband/HBM-TA4F, Collar/CM-60, Over-the-Ear/EM-TA4F, or Lapel/LM-60

Technical Specifications	
Rated Power Output	150 watts AC / 125 watts DC
Max SPL @ Rated Power	120 dB @ 1 meter
Battery	Two 12V sealed lead acid rechargeable, 9.0 AH Full recharge: approx 7 hrs
Frequency Response	60 Hz - 15 kHz ± 3dB
Wireless Range	150' line of sight
Line Output (post fader)	isolated, 600 W, 1/4" phone
AC Power Reqs.	100 - 240 VAC, 50/60 Hz, 250W max
USB	5V 500mA
Dimensions Closed (HWD)	28" x 18.5" x 11" (71.1 x 47 x 28 cm)
Dimensions Opened (HWD)	71.5" x 18.5" x 11" (181.6 x 47 x 28 cm)
Weight	60 lbs / 27.2 Kg
Mic Inputs:	Lo-Z (1 KW), balanced, XLR 12 VDC condenser mic (phantom) power Hi-Z (10 KW), unbalanced, 1/4" phone Hi-Z (10 KW), unbalanced, 1/8" stereo
Line In	Stereo RCA, stereo 3.5 mm, 1/4" balanced
Sensitivity For Rated Output	
Lo-Z Microphone	-52 dBV (2.5 mVrms)
Hi-Z Microphone	-43 dBV (7.5 mVrms)
Auxiliary (line)	-14 dBV (200 mVrms)
Phantom Power	36V



(Features & Specifications Subject to Change Without Notice)